

Attic Access Door and Panel Installation

ThermaBuilt™ Attic Access Door and Panels doors are an alternative to drop-down stairs. Units come complete with all components and all that is required for the installer is to insert into either the drop-down stair rough opening or the scuttle door rough opening.

Location Of Access Door And Prep-Work

Select a location to install the ThermaBuilt™ Access Panel. Insure there are no obstruction in placement like electrical, plumbing or any other items that would prevent this location from being the installation point. **ANY MODIFICATION TO TRUSSES MUST BE TO CURRENT BUILDING CODE, APPROVED BY AN ENGINEER AND IS THE RESPONSIBLTY OF THE INSTALLER.** If any truss or ceiling joist must be cut, consult with an Engineer. It is required on both units to install a header between the trusses.

Framing of Opening

ThermaBuilt™ Access Panels with hinges can either be installed in the opening for a disappearing stair way or the ThermaBuilt™ Attic Access Panel can fit within trusses that are 24" on center. All units should have a header block on the narrow ends to create a square frame for on which the panel will install.

Installing the ThermaBuilt™ Access Doors or Panel

It is best if 2 people install the unit. Make sure that the unit bottom edge is flush with the sheetrock. On hinged units, the hinges is in the attic space. On the non-hinged panel make sure the panel will push up into the attic space. Once aligned with sheetrock, shim as necessary and make sure the unit is square. **FAILURE TO ENSURE SQUARENESS WILL RESULT IN UNIT NOT PROPERLY CLOSING.** Pre-drill for 16 pd nail to keep from splitting the jamb of the unit. On the ThermaBuilt™ Access Door unit with hinges, install 4, 16 pd nails along the side and 3 along each head. On the ThermaBuilt™ Attic Access Panel (no Hinges) install 3, 16 pd nails along the side and 2 along each head. Refer to Figure 1.1, Figure 1.2 and Figure 1.3 for diagram of ThermaBuilt™ Access Panel proper installation. After panels are nailed, fill any gaps between the framework and the blocking with insulation. Finish the install with the moulding of choice, extending 1/8" beyond the ThermaBuilt™ Access Door or panel jamb.

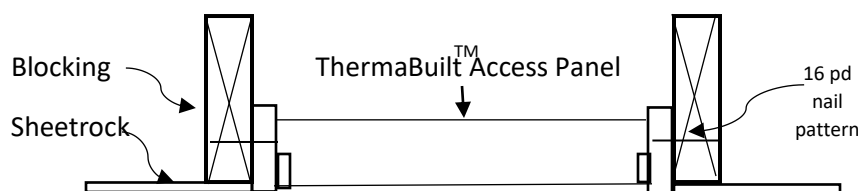
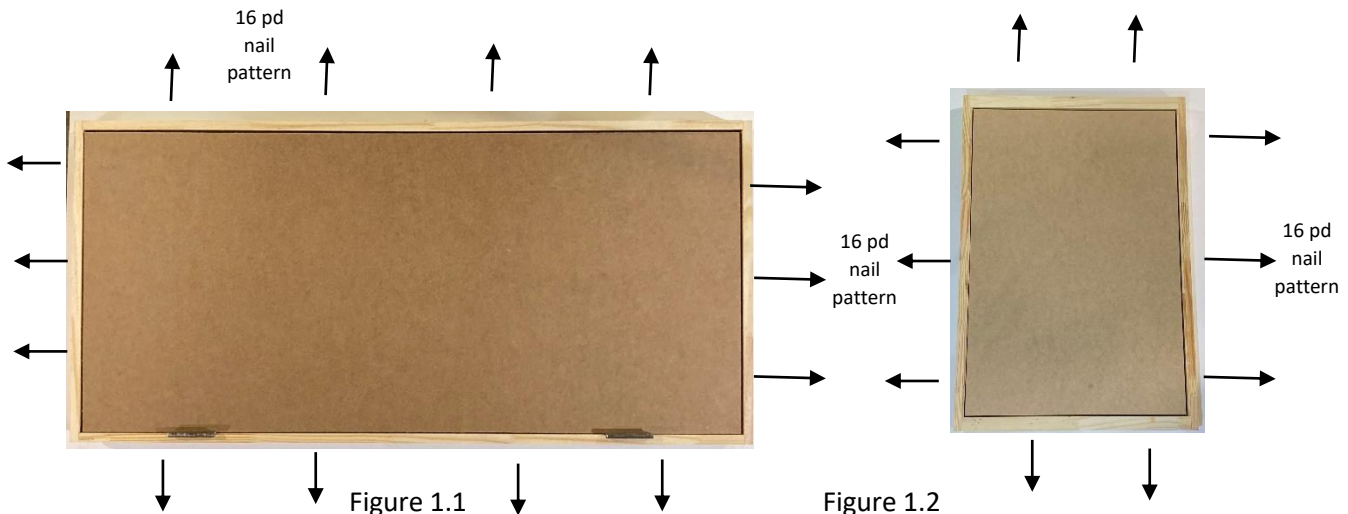

Figure 1.3